

# valvole di non ritorno

non-return valves

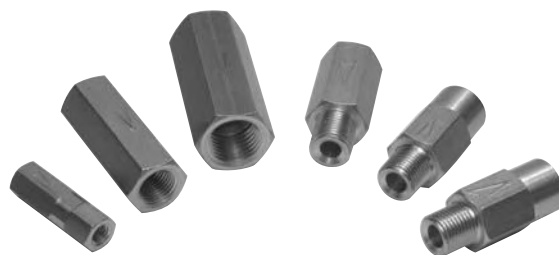

- Attacchi filettati femmina-femmina e maschio-femmina  
*Threaded ports female-female and male-female*
- Da M5 a G1/4"  
*From M5 to G1/4"*
- A richiesta corpo nichelato  
*Nickel plated valve body on request*
- Guarnizioni in Viton per temperature più elevate  
*Viton seals for higher temperatures*



3

## Materiali

Corpo: ottone OT58

Molla: INOX

Guarnizioni: NBR

Parti interne: ottone OT58

## Materials

Body: brass OT58

Spring: stainless steel

Seals: NBR

Internal parts: brass OT58

| Modello<br><i>Model</i>                                       | VNR 1/8 FF<br>VNR 1/8 MF   | VNR 1/4 FF<br>VNR 1/4 MF | VNR M5 FF  | VNR 1/8 MFR |
|---|--|--------------------------|------------|-------------|
| Attacchi<br><i>Ports</i>                                      | G1/8"  | G1/4"                    | M5         | G1/8"       |
| Diametro nominale<br><i>Nominal orifice</i>                   | 5.2 mm   | 7 mm                     | 2.2 mm     | 4 mm        |
| Portata nominale a 6 bar<br><i>Nominal flow rate at 6 bar</i> | 500 NI/min   | 900 NI/min               | 100 NI/min | 350 NI/min  |
| Temperatura di esercizio<br><i>Temperature range</i>          | max +60°C<br>VITON: max +110°C   |                          |            |             |
| Pressione di esercizio<br><i>Working pressure</i>             | 2 ... 10 bar<br>0.2 ... 1 MPa  |                          |            |             |
| Fluido<br><i>Fluid</i>  | Aria filtrata 50μ con o senza lubrificazione<br>50μ filtered, lubricated or non lubricated air |                          |            |             |

# valvole di non ritorno

non-return valves



## VNR M5 FF

valvola di non ritorno femmina-femmina M5  
non-return valve female-female M5

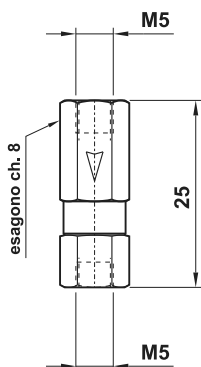

### Versioni disponibili - Available versions

| codice - code | descrizione - description  |
|---------------|--|
| 11.010.4      | <b>standard:</b> corpo in ottone, guarnizioni in NBR<br><i>standard: valve body in brass, seals in NBR</i>   |
| 11.011.4      | corpo in ottone, guarnizioni in NBR, senza molla<br><i>valve body in brass, seals in NBR, without spring</i> |
| 11.024.4      | corpo in ottone nichelato, guarnizioni in NBR<br><i>valve body in nickel plated brass, seals in NBR</i>      |
| 11.046.4      | corpo in ottone, guarnizioni in VITON<br><i>valve body in brass, seals in VITON</i>                          |
| 11.050.4      | corpo in ottone nichelato, guarnizioni in VITON<br><i>valve body in nickel plated brass, seals in VITON</i>  |

## VNR 1/8 FF

valvola di non ritorno femmina-femmina 1/8"  
non-return valve female-female 1/8"

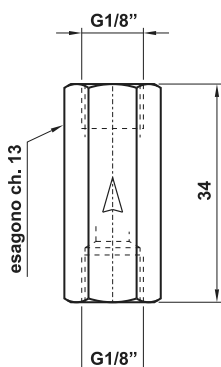

### Versioni disponibili - Available versions

| codice - code | descrizione - description  |
|---------------|--|
| 11.000.4      | <b>standard:</b> corpo in ottone, guarnizioni in NBR<br><i>standard: valve body in brass, seals in NBR</i>           |
| 11.002.4      | corpo in ottone, guarnizioni in VITON<br><i>valve body in brass, seals in VITON</i>                                  |
| 11.004.4      | corpo in ottone nichelato, guarnizioni in NBR<br><i>valve body in nickel plated brass, seals in NBR</i>              |
| 11.009.4      | corpo in ottone, guarnizioni in SILICONE<br><i>valve body in brass, seals in SILICON</i>                             |
| 11.027.4      | corpo in ottone, guarnizioni in NBR, senza molla<br><i>valve body in brass, seals in NBR, without spring</i>         |
| 11.031.4      | corpo in ottone nichelato, guarnizioni in VITON<br><i>valve body in nickel plated brass, seals in VITON</i>          |
| 11.035.4      | corpo in ottone, guarnizioni in NBR, molla tenera<br><i>valve body in brass, seals in NBR, light duty spring</i>     |
| 11.034.4      | corpo in ottone, guarnizioni in VITON, molla tenera<br><i>valve body in brass, seals in VITON, light duty spring</i> |

## VNR 1/8 MF

valvola di non ritorno maschio-femmina 1/8"  
non-return valve male-female 1/8"

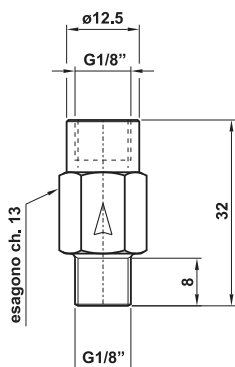

### Versioni disponibili - Available versions

| codice - code | descrizione - description  |
|---------------|--|
| 11.006.4      | <b>standard:</b> corpo in ottone, guarnizioni in NBR<br><i>standard: valve body in brass, seals in NBR</i>     |
| 11.007.4      | corpo in ottone, guarnizioni in VITON<br><i>valve body in brass, seals in VITON</i>                            |
| 11.042.4      | corpo in ottone, guarnizioni in NBR, molla dura<br><i>valve body in brass, seals in NBR, heavy duty spring</i> |
| 11.055.4      | corpo in ottone nichelato, guarnizioni in NBR<br><i>valve body in nickel plated brass, seals in NBR</i>        |
| 11.045.4      | corpo in ottone nichelato, guarnizioni in VITON<br><i>valve body in nickel plated brass, seals in VITON</i>    |

# valvole di non ritorno

non-return valves



## VNR 1/8 MFR

valvola di non ritorno maschio-femmina 1/8" rovesciata  
non-return valve female-male 1/8"

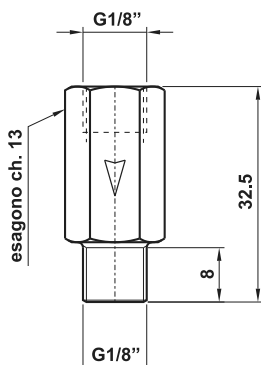

### Versioni disponibili - Available versions

| codice - code | descrizione - description   |
|---------------|---|
| 11.008.4      | <b>standard:</b> corpo in ottone, guarnizioni in NBR<br><i>standard: valve body in brass, seals in NBR</i>  |
| 11.032.4      | corpo in ottone, guarnizioni in VITON<br><i>valve body in brass, seals in VITON</i>                         |
| 11.049.4      | corpo in ottone nichelato, guarnizioni in NBR<br><i>valve body in nickel plated brass, seals in NBR</i>     |
| 11.056.4      | corpo in ottone nichelato, guarnizioni in VITON<br><i>valve body in nickel plated brass, seals in VITON</i> |

## VNR 1/4 FF

valvola di non ritorno femmina-femmina 1/4"  
non-return valve female-female 1/4"

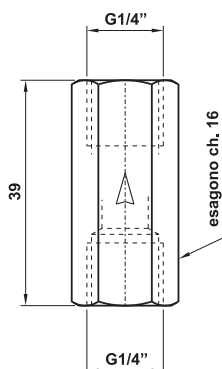

### Versioni disponibili - Available versions

| codice - code | descrizione - description  |
|---------------|--|
| 11.001.4      | <b>standard:</b> corpo in ottone, guarnizioni in NBR<br><i>standard: valve body in brass, seals in NBR</i>           |
| 11.003.4      | corpo in ottone, guarnizioni in VITON<br><i>valve body in brass, seals in VITON</i>                                  |
| 11.005.4      | corpo in ottone nichelato, guarnizioni in NBR<br><i>valve body in nickel plated brass, seals in NBR</i>              |
| 11.030.4      | corpo in ottone nichelato, guarnizioni in VITON<br><i>valve body in nickel plated brass, seals in VITON</i>          |
| 11.028.4      | corpo in ottone, guarnizioni in NBR, senza molla<br><i>valve body in brass, seals in NBR, without spring</i>         |
| 11.037.4      | corpo in ottone, guarnizioni in VITON, senza molla<br><i>valve body in brass, seals in VITON, without spring</i>     |
| 11.036.4      | corpo in ottone, guarnizioni in NBR, molla tenera<br><i>valve body in brass, seals in NBR, light duty spring</i>     |
| 11.033.4      | corpo in ottone, guarnizioni in VITON, molla tenera<br><i>valve body in brass, seals in VITON, light duty spring</i> |
| 11.040.4      | corpo in ottone, guarnizioni in VITON, molla dura<br><i>valve body in brass, seals in VITON, heavy duty spring</i>   |

## VNR 1/4 MF

valvola di non ritorno maschio-femmina 1/4"  
non-return valve male-female 1/4"

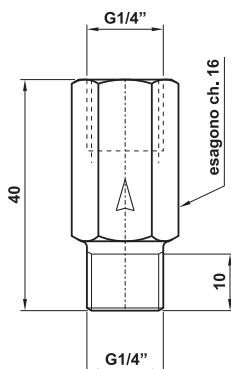

### Versioni disponibili - Available versions

| codice - code | descrizione - description   |
|---------------|---|
| 11.047.4      | <b>standard:</b> corpo in ottone, guarnizioni in NBR<br><i>standard: valve body in brass, seals in NBR</i>  |
| 11.048.4      | corpo in ottone nichelato, guarnizioni in NBR<br><i>valve body in nickel plated brass, seals in NBR</i>     |
| 11.059.4      | corpo in ottone nichelato, guarnizioni in VITON<br><i>valve body in nickel plated brass, seals in VITON</i> |

# valvole di non ritorno

non-return valves



## VNR 3/8 FF

valvola di non ritorno femmina-femmina 3/8"

non-return valve female-female 3/8"



### Versioni disponibili - Available versions

| codice - code | descrizione - description  |
|---------------|--|
| 11.053.4      | <b>standard:</b> corpo in ottone nichelato, guarnizioni in NBR<br><i>standard: valve body in nickel plated brass, seals in NBR</i> |

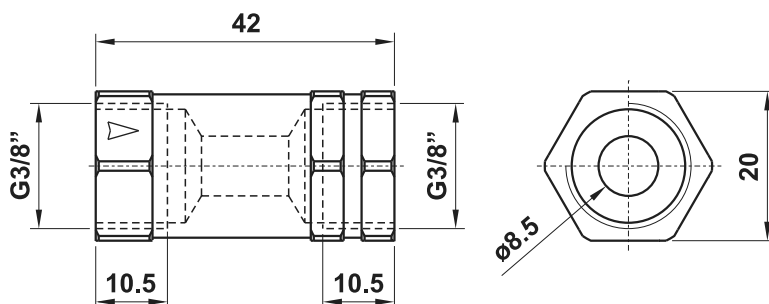

## VNR 1/2 FF

valvola di non ritorno femmina-femmina 1/2"

non-return valve female-female 1/2"



### Versioni disponibili - Available versions

| codice - code | descrizione - description  |
|---------------|--|
| 11.103.4      | <b>standard:</b> corpo in ottone nichelato, guarnizioni in NBR<br><i>standard: valve body in nickel plated brass, seals in NBR</i> |

