

Schnellverschraubungen

push-on fittings

Raccordi a calzamento

Technische Daten

Betriebstemperatur	-20 °C bis +80 °C (NBR-Dtg.) -20 °C bis +70 °C (PVC-Dtg.)	abhängig von den Temperatureigenschaften des Schlauches
Betriebsdruck	bis 20 bar	abhängig vom Druckbereich des eingesetzten Schlauches
Werkstoffe	Körper und Überwurfmutter Messing vernickelt O-Ringe aus NBR Dichtungen aus PVC	CW614N und CW617N
Gewinde	zyl. Gew. DIN EN ISO 228 kon. Gew. DIN EN 10226 (DIN 2999) metr. Gew. DIN ISO 262	zylindrisch mit O-Ring-Abdichtung
Medium	pneumatische, ölhydraulische und hydraulische Kreisläufe	
Schläuche	geeignet für diverse Kunststoffschläuche	auch für PVU synthesefadenarmiert

Technical Data

Operating temperature	-20 °C up to +80 °C (NBR-Sealing) -20 °C up to +70 °C (PVC-Sealing)	Dependent on the tube's temperature
Operating pressure	Up to 20 bar	Dependent on the pressure range of the tube used
Materials	Body and swivel nut, brass, nickel-plated NBR O-rings PVC seals	CW614N and CW617N
Thread	Cyl. thread, DIN EN ISO 228 Con. thread, DIN EN 10226 (DIN 2999) Metr. thread, DIN ISO 262	Cylindrical with O-ring seal
Medium	Pneumatic, oil-hydraulic and hydraulic circuits	
Tubes	Suitable for various plastic tubes	Also for reinforced PVU synthetic fibres



Dati tecnici

Temperatura di esercizio	Da -20 °C a +80 °C (guarniz. NBR) Da -20 °C a +70 °C (guarniz. PVC)	In funzione delle caratteristiche termiche del tubo
Pressione di esercizio	fino a 20 bar	In funzione del campo di pressione del tubo utilizzato
Materiali	Corpo e dado in ottone (Ms58) nichelato O-Ring in NBR Guarnizioni in PVC	
Filetto	Fil. cilindrico DIN EN ISO 228 Fil. conico DIN EN 10226 (DIN 2999) Fil. metrico DIN ISO 262	Cilindrico con guarnizione O-Ring
Settori di utilizzo	Circuiti pneumatici, oleoidraulici e idraulici	
Tubi	Idoneo per vari tubi di plastica	Anche per PVU rinforzato con fibre sintetiche

RZ120

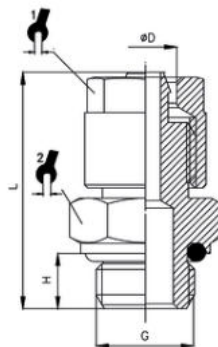
Gerade Einschraubverschraubung zyl. mit O-Ring
 Straight male adaptor cyl. with O-ring
 Diritto maschio cilindrico con O-Ring



Code	ØD	G	H	L		
RZ120-4/2,7-M5	4/2,7	M5	4	19,5	7	8
RZ120-4/2,7-1/8	4/2,7	G1/8	6	25	7	13
RZ120-4,3/3-M5	4,3/3	M5	4	20	8	8
RZ120-4,3/3-1/8	4,3/3	G1/8	6	25	8	13
RZ120-5/3-M5	5/3	M5	4	20	8	8
RZ120-5/3-1/8	5/3	G1/8	5,5	23,5	8	13
RZ120-6/4-M5	6/4	M5	4	20	9	8
RZ120-6/4-1/8	6/4	G1/8	5,5	23,5	10	13
RZ120-6/4-1/4	6/4	G1/4	6,5	25,5	10	16
RZ120-6/4-3/8	6/4	G3/8	9	28	10	19
RZ120-6/4-1/2	6/4	G1/2	10	30	10	24
RZ120-8/6-1/8	8/6	G1/8	5,5	23	12	14
RZ120-8/6-1/4	8/6	G1/4	6,5	25,5	12	16
RZ120-8/6-3/8	8/6	G3/8	9	28	12	19
RZ120-8/6-1/2	8/6	G1/2	10	30	12	24
RZ120-10/8-1/8	10/8	G1/8	5,5	26,5	14	14
RZ120-10/8-1/4	10/8	G1/4	6,5	28,5	14	16
RZ120-10/8-3/8	10/8	G3/8	9	30	14	19
RZ120-10/8-1/2	10/8	G1/2	10	32	14	24
RZ120-12/9-1/4	12/9	G1/4	8	31	15	17
RZ120-12/9-3/8	12/9	G3/8	9	32,5	15	19
RZ120-12/10-3/8	12/10	G3/8	9	30,5	15	19
RZ120-12/10-1/2	12/10	G1/2	10	32,5	15	24
RZ120-15/12,5-1/2	15/12,5	G1/2	10	34,5	22	24