

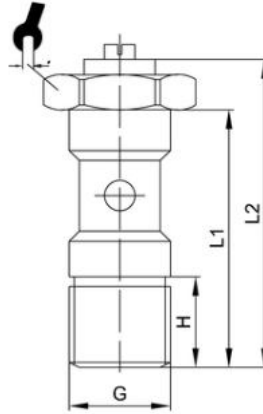

RGB053, RGB063, RGB073

mit Schlitzschraube

Screw for flow regulation with slotted screw

Vite di regolazione con regolazione a cacciavite



Code	Typ	G	H	L1	L2		NI/min*
RGB053-M5	B	M5	4,5	16,5	25	8	45
RGB063-1/8	A	G1/8	6	23,5	32	14	310
RGB063-1/4	A	G1/4	8,5	27	37	17	810
RGB053-1/8	B	G1/8	6	23,5	32	14	310
RGB053-1/4	B	G1/4	8,5	27	37	17	810
RGB073-1/8	C	G1/8	6	23,5	32	14	310
RGB073-1/4	C	G1/4	8,5	27	37	17	810
RGB053-3/8	B	G3/8	7	30	46	20	1040
RGB063-1/2	A	G1/2	12,5	39	52,5	26	2200
RGB053-1/2	B	G1/2	12,5	39	52,5	26	2200

* Ermittlung der Durchflusswerte bei 6 bar * Evaluation of flow rate at 6 bar
* portata nominale a 6 bar

Körper:	CW614N vernickelt
Body:	CW614N nickel-plated
Corpo:	ottone CW 614N nichelato
O-Ring:	NBR
O-Rings:	NBR
O-Ring:	NBR 70 SH
zyl. Gewinde:	DIN EN ISO 228
cyl. Threads:	DIN EN ISO 228
Filettatura:	gas cilindrica ISO 228
Betriebstemperatur:	-20°C bis +80°C
Working temperature:	-20°C up to +80°C
Temperatura di utilizzo:	da -20°C a +80°C
Betriebsdruck:	max. 10 bar
Working pressure:	max. 10 bar
Pressione di utilizzo:	max. 10 bar

für geölte und ungeölte Druckluft
for lubricated and non-lubricated compressed air
per aria compressa sia lubrificata che non

A = Zuluft / for valves / per valvola B = Abluft / for cylinders / per cilindro C
= Beidseitig / bidirectional /bidirezionale