

Standardverschraubungen

Standard fittings

Raccordi Filettati Standard

Technische Daten

Betriebstemperatur	max. +150 °C	abhängig von den Temperatureigenschaften des Schlauches
Betriebsdruck	bis 60 bar	abhängig vom Druckbereich des eingesetzten Schlauches/ Rohres und der verwendeten Temperatur
Werkstoffe	Messing vernickelt bzw. blank	CW614N und CW617N
Gewinde	zyl. Gew. DIN EN ISO 228 kon. Gew. DIN EN 10226 (ISO7 / DIN 2999) metr. Gew. DIN ISO 262	
Medium	pneumatische, ölhydraulische und hydraulische Kreisläufe	

Technical Data

Operating temperature	max. +150 °C	Dependent on the temperature range of the tube/pipe used
Operating pressure	up to 16 bar	Dependent on the pressure range of the tube/pipe used and the temperature used
Materials	Brass, nickel-plated or polished	CW614N and CW617N
Thread	Cyl. thread, DIN EN ISO 228 Con. thread, DIN EN 10226 (ISO7 / DIN Medium 2999) Metr. thread, DIN ISO 262	
Medium	Pneumatic, oil-hydraulic and hydraulic circuits	

Dati tecnici

Temperatura di esercizio	max. +150 °C	In funzione del campo di temperatura del tubo flessibile/rigido utilizzato
Pressione di esercizio	fino a 60 bar	In funzione del campo di pressione del tubo flessibile/rigido utilizzato e della temperatura di esercizio
Materiali	Ottone (Ms58) nichelato o lucidato	
Filetto	Fil. cilindrico DIN EN ISO 228 Fil. conico DIN EN 10226 (ISO7/DIN 2999) Fil. metrico DIN ISO 262	
Fluidi utilizzabili	Circuiti pneumatici, oleoidraulici e idraulici	

RC341

Schlauchtülle zylindrisch
Male hose adapter cyl.
Portagomma maschio cilindrico

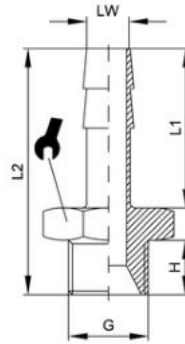

Code	LW	G	H	L1	L2	
RC341-4,5-M5	4,5	M5	4	15	22,5	8
RC341-6-1/8	6	G1/8	6	19	29,5	12
RC341-6-1/4	6	G1/4	8	19	32	14
RC341-7-1/8	7	G1/8	6	19	29,5	12
RC341-7-1/4	7	G1/4	8	19	32	14
RC341-8-1/8	8	G1/8	6	19	29,5	12
RC341-8-1/4	8	G1/4	8	19	32	14
RC341-8-3/8	8	G3/8	9	19	33	19
RC341-9-1/8	9	G1/8	6	19	29,5	12
RC341-9-1/4	9	G1/4	8	19	32	14
RC341-9-3/8	9	G3/8	9	19	33	19
RC341-10-1/8	10	G1/8	6	20	30,5	12
RC341-10-1/4	10	G1/4	8	20	33	14
RC341-10-3/8	10	G3/8	9	20	34	19
RC341-12-1/4	12	G1/4	8	20	33	14
RC341-12-3/8	12	G3/8	9	20	34	19
RC341-12-1/2	12	G1/2	10	20	35,5	22
RC341-14-3/8	14	G3/8	9	22	36	19
RC341-14-1/2	14	G1/2	10	22	37,5	22
RC341-17-3/8	17	G3/8	9	24	38	19
RC341-17-1/2	17	G1/2	10	24	39,5	22
RC341-18-3/4	18	G3/4	11	24	41,5	30
RC341-20-1/2	20	G1/2	10	24	39,5	22
RC341-20-3/4	20	G3/4	11	24	41,5	30