

## Description

Glycerine filled stainless steel case centre back entry. For pneumatic industry, gases and liquids not viscous, not aggressive and not crystallising.



### MX-63 ... A

DN63 pressure gauges.

Part No	Pressure Range	Connection
MX-63-1/0A	-1/0 bar/in Hg	G1/4B
MX-63-1/1.5A	-1+1.5 bar/in hg	G1/4B
MX-63-1/3A	-1+3 bar	G1/4B
MX-63-1/5A	-1+5 bar	G1/4B
MX-63-0/1A	0-1 bar/psi	G1/4B
MX-63-0/1.6A	0-1.6 bar/psi	G1/4B
MX-63-0/2.5A	0-2.5 bar/psi	G1/4B
MX-63-0/4A	0-4 bar/psi	G1/4B
MX-63-0/6A	0-6 bar/psi	G1/4B
MX-63-0/10A	0-10 bar/psi	G1/4B
MX-63-0/12A	0-12 bar/psi	G1/4B
MX-63-0/16A	0-16 bar/psi	G1/4B
MX-63-0/25A	0-25 bar/psi	G1/4B
MX-63-0/40A	0-40 bar/psi	G1/4B
MX-63-0/60A	0-60 bar/psi	G1/4B
MX-63-0/100A	0-100 bar/psi	G1/4B
MX-63-0/160A	0-160 bar/psi	G1/4B
MX-63-0/250A	0-250 bar/psi	G1/4B
MX-63-0/315A	0-315 bar/psi	G1/4B
MX-63-0/400A	0-400 bar/psi	G1/4B
MX-63-0/600A	0-600 bar/psi	G1/4B
MX-63-0/1000A	0-1000 bar/psi	G1/4B

## Overall dimensions (mm)

### MX-63 ... A

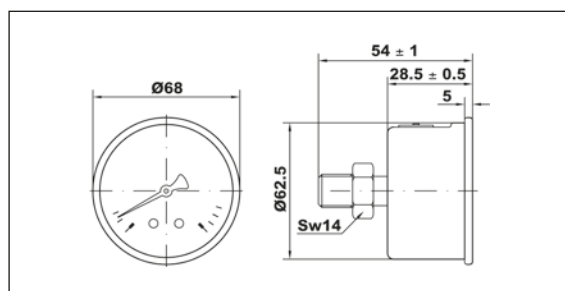

**Customizations****Model**

MF-63 - Mounting bracket - Separately supplied



MF-63

## Features

Materials	MX-63 ... A
Case + roll on bezel	Stainless steel AISI 304 with blow-out device
Case + roll on bezel	Vedril PMMA
Dial	White aluminium
Pointer	Black plastic
Pressure connection	Cu-alloy, 14 mm flats
Pressure element	Bourdon tube Cu-alloy, soft soldered $\leq 60$ bar C-type, $> 60$ bar helical type Sn-Ag soldered
Movement	Cu-alloy
Liquid filling	Glycerine 99.5%

Technical features	
Design	EN 837-1
Working pressure	Steady: 75% of full scale value Fluctuating: 60% of full scale value Short time: full scale value
Temperature limits	Ambient: $-20 \dots +60^{\circ}\text{C}$ Medium: $+60^{\circ}\text{C}$ maximum Storage: $-20 \dots +60^{\circ}\text{C}$
Temperature effect	Deviation from reference temperature ( $+20^{\circ}\text{C}$ ): $\pm 0,04\%/1\text{K}$ of the span
Accuracy class: MX-63	cl. 1.6
Degree of protection	IP 65 for EN 60 529 / IEC 529
Individual weight: MX-63 ... A	0.209 kg